

**FLAP VALVE MOON**  
metal/rubber sealed  
**DN 50 - 1000 PN10/16**

11.701



**Product description**

- Flap valve series MOON for waste water and sea water
- Service temperature from 0°C (excluding frost) to 70°C

**Standards**

- Flange drilling to EN 1092-2 PN10/16

**Corrosion protection**

- Epoxy powder coating RAL 3011
- Applied internal and external with a minimum coating thickness of 250 µm
- Fusion bonded epoxy coating according EN 14901 and GSK (RAL-GZ662) guidelines

**Features**

- Valve with self-operating flap obturator
- Full bore
- The valve opens under direct pressure to relieve fluid, allowing the water to drain when the pressure is relieved, preventing fluids from returning when the tide rises
- The valve sealing area has an 8° inclination to guarantee automatic closing after the fluid has come out. This inclination allows the obturator to exert sufficient force to prevent the ingress of fluid in the opposite direction.
- Minimum opening pressure is 0.1 bar
- The obturator was sealed to reduce noise and increase the coating's endurance
- Can be installed directly on flanges or previously straightened masonry surfaces by steel anchors prior to being planed
- On request possibility to be supplied with counterweight.



100% MADE IN EUROPE



**Fucoli Somepal**  
FUNDAÇÃO DE FERRO, S. A.

Visit our website at [www.fucoli-somepal.pt](http://www.fucoli-somepal.pt)

**Head office:** Estrada de Coselhas, 3000-125 Coimbra – Portugal | Tel.: (+351) 239 490100 | Fax: (+351) 239 490198

**Branch office:** Rua de Aveiro 50, 3050-420 Pampilhosa – Portugal | Tel.: (+351) 239 490100 | Fax: (+351) 231 949292 | [comercial@fucoli-somepal.pt](mailto:comercial@fucoli-somepal.pt)

**FLAP VALVE MOON**  
**metal/rubber sealed**  
**DN 50 - 1000 PN10/16**

11.701



Flap valve Moon

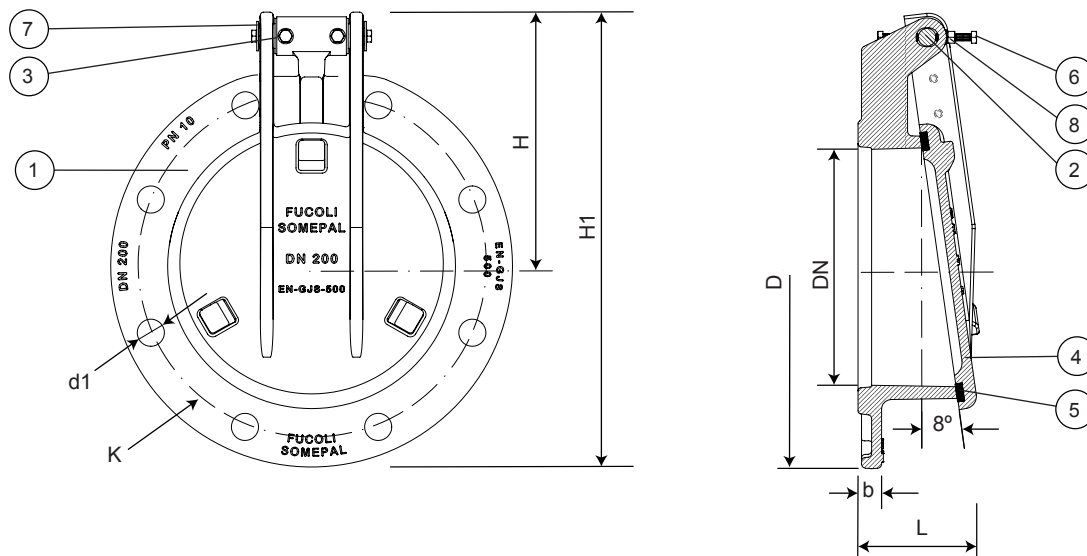

**Component list**

pos.	components	material	standard
1	Body	Ductile iron EN-GJS-500-7	EN 1563
2	Shaft	Stainless steel AISI 316L	EN 10088 - 1
3	Bushing	POM	-
4	Disc/ Obturator	Ductile iron EN-GJS-500-7	EN 1563
5	Sealing	Elastomer NBR	EN 681 - 1
6	Bolts	Stainless steel A2	EN 10088 - 1
7	Washers	Stainless steel A2	EN 10088 - 1
8	Nuts	Stainless steel A4	EN 10088 - 1

**Reference and dimensions**

DN	PN	code	D	L	H	H1	K	n° x d1	b	Kg
			mm	mm	mm	mm	mm	mm	mm	approx.
50/60/65	10/16	10785490	185	78	133	226	125/145	4 x 19	19	4
80	10/16	10785495	200	80	154	255	160	8 x 19	19	5
100	10/16	10785500	220	80	154	265	180	8 x 19	19	6
150	10/16	10785505	285	95	184	327	240	8 x 23	19	9
200	10	10785510	340	100	215	386	295	8 x 23	20	14
200	16	10785513	340	100	215	386	295	12 x 23	20	14
250	10	10785515	400	115	252	453	350	12 x 23	22	22
250	16	10785518	400	115	252	453	355	12 x 28	22	22
300	10	10785520	455	125	280	508	400	12 x 23	24.5	28
300	16	10785523	455	125	280	508	410	12 x 28	24.5	28
350	10	10785525	520	140	321	582	460	16 x 23	24.5	50
350	16	10785528	520	140	321	582	470	16 x 28	26.5	50
400	10	10785530	580	150	351	642	515	16 x 28	24.5	50
400	16	10785533	580	150	351	642	525	16 x 31	28	50
450	10	10785535	615	155	370	678	565	20 x 28	25.5	56
450	16	10785538	640	155	370	678	585	20 x 31	30	64
500	10	10785540	670	160	400	736	620	20 x 28	26.5	66
500	16	10785543	715	160	400	736	650	20 x 34	31.5	75
600	10	10785545	780	185	460	851	725	20 x 31	30	97
600	16	10785548	840	185	460	851	770	20 x 37	36	117

continued on next page

# FLAP VALVE MOON

metal/rubber sealed  
DN 50 - 1000 PN10/16

11.701



continued from previous page

## Reference and dimensions

DN	PN	code	D mm	L mm	H mm	H1 mm	K mm	n° x d1 mm	b mm	Kg approx.
700	10	10785550	895	210	520	969	840	24 x 31	32.5	130
700	16	10785553	910	210	520	969	840	24 x 37	39.5	150
800	10	10785555	1015	230	582	1091	950	24 x 34	35	180
800	16	10785558	1025	230	582	1091	950	24 x 41	43	200
900	10	10785560	1115	255	646	1210	1050	28 x 34	37.5	200
900	16	10785563	1125	255	646	1210	1050	28 x 41	46.5	250
1000	10/16	10785565	1230/1255	285	712	1340	1160/1170	28 x 37/44	50	295

Flap valve Moon with counterweight

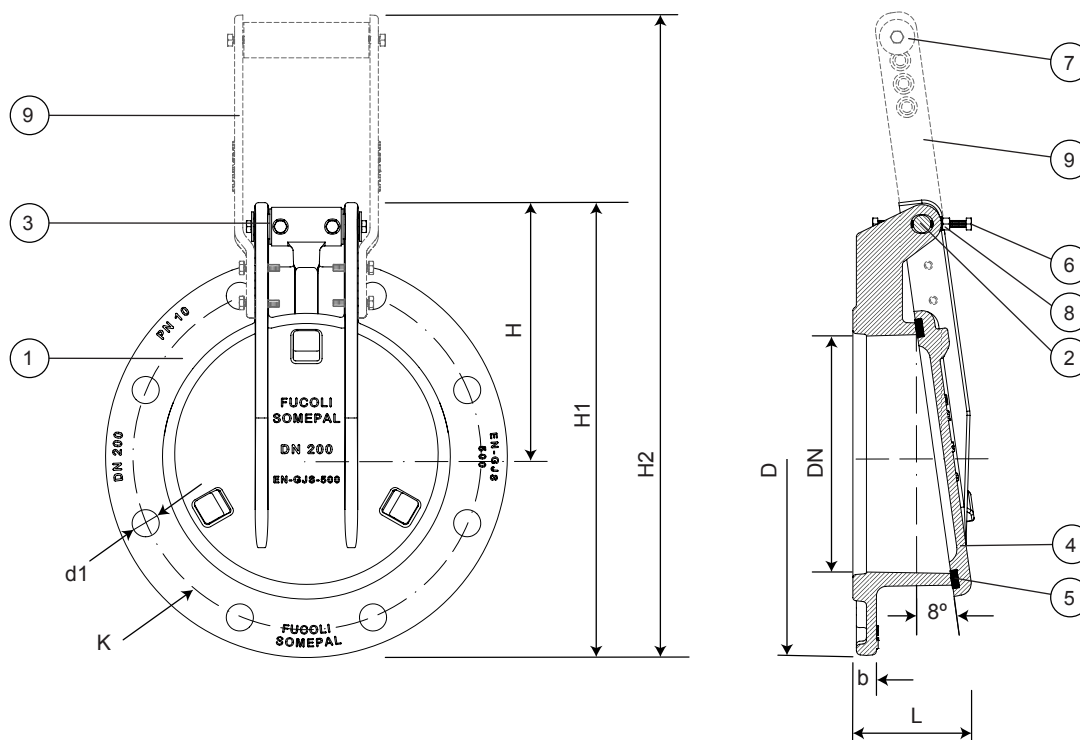

## Component list

pos.	components	material	standard
1	Body	Ductile iron EN-GJS-500-7	EN 1563
2	Shaft	Stainless steel AISI 316L	EN 10088 - 1
3	Bushing	POM	-
4	Disc/ Obturator	Ferro Fundido Dúctil EN-GJS-500-7	EN 1563
5	Sealing	Elastomer NBR	EN 681 - 1
6	Bolts	Stainless steel A2	EN 10088 - 1
7	Washers	Stainless steel A2	EN 10088 - 1
8	Nuts	Stainless steel A4	EN 10088 - 1
9	Counterweight	Ductile iron EN-GJS-500-7	EN 1563

## Referências e dimensões

DN	PN	code	D mm	L mm	H mm	H1 mm	H2 mm	K mm	n° x d1 mm	b mm	Kg approx.
50/60/65	10/16	10785590	185	78	133	226	322	125/145	4 x 19	19	6
80	10/16	10785595	200	80	154	255	348	160	8 x 19	19	7
100	10/16	10785600	220	80	154	265	358	180	8 x 19	19	8
150	10/16	10785605	285	95	184	327	490	240	8 x 23	19	11

continued on next page

**FLAP VALVE MOON**  
**metal/rubber sealed**  
**DN 50 - 1000 PN10/16**

11.701



continuação da página anterior

**Reference and dimensions**

DN	PN	code	D mm	L mm	H mm	H1 mm	H2 mm	K mm	n° x d1 mm	b mm	Kg approx.
200	10	10785610	340	100	215	386	545	295	8 x 23	20	17
200	16	10785613	340	100	215	386	545	295	12 x 23	20	17
250	10	10785615	400	115	252	453	612	350	12 x 23	22	25
250	16	10785618	400	115	252	453	612	355	12 x 28	22	25
300	10	10785620	455	125	280	508	716	400	12 x 23	24.5	31
300	16	10785623	455	125	280	508	716	410	12 x 28	24.5	31
350	10	10785625	520	140	321	582	786	460	16 x 23	24.5	55
350	16	10785628	520	140	321	582	786	470	16 x 28	26.5	55
400	10	10785630	580	150	351	642	896	515	16 x 28	24.5	55
400	16	10785633	580	150	351	642	896	525	16 x 31	28	55
450	10	10785635	615	155	370	678	974	565	20 x 28	25.5	61
450	16	10785638	640	155	370	678	974	585	20 x 31	30	69
500	10	10785640	670	160	400	736	1036	620	20 x 28	26.5	71
500	16	10785643	715	160	400	736	1036	650	20 x 34	31.5	80
600	10	10785645	780	185	460	851	1176	725	20 x 31	30	102
600	16	10785648	840	185	460	851	1176	770	20 x 37	36	122
700	10	10785650	895	210	520	969	1334	840	24 x 31	32.5	135
700	16	10785653	910	210	520	969	1334	840	24 x 37	39.5	155
800	10	10785655	1015	230	582	1091	1483	950	24 x 34	35	185
800	16	10785658	1025	230	582	1091	1483	950	24 x 41	43	205
900	10	10785660	1115	255	646	1210	1642	1050	28 x 34	37.5	205
900	16	10785663	1125	255	646	1210	1642	1050	28 x 41	46.5	255
1000	10/16	10785665	1230/1255	285	712	1340	1770	1160/1170	28 x 37/44	50	300



**Fucoli Somepal**  
 FUNDIÇÃO DE FERRO, S.A.

Visit our website at [www.fucoli-somepal.pt](http://www.fucoli-somepal.pt)

Head office: Estrada de Coselhas, 3000-125 Coimbra – Portugal | Tel.: (+351) 239 490100 | Fax: (+351) 239 490198

Branch office: Rua de Aveiro 50, 3050-420 Pampilhosa – Portugal | Tel.: (+351) 239 490100 | Fax: (+351) 231 949292 | [comercial@fucoli-somepal.pt](mailto:comercial@fucoli-somepal.pt)

