

Loading Data

Size	Max. Recommended Load [N]
1/2"-2"	1800
2-1/2"-4"	2700
6"	4500
8"	5600

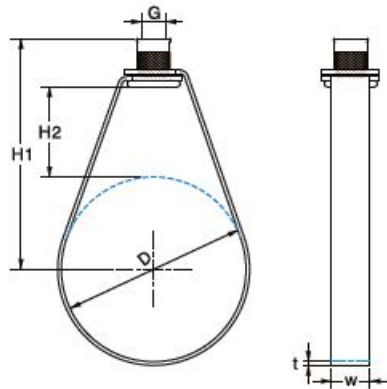

Article Number	Clamping Range			Dimensions [mm]				UL Approved	FM Approved	Pack Size [pcs]
	DN	D[mm]	[inch]	w x t	G	H1	H2			
0906 330 001	15	21.3	1/2	16x1.2	M10	62	29	●	—	100
0906 330 002	20	26.9	3/4	16x1.2	M10	63	27	●	●	100
0906 330 003	25	33.7	1	16x1.2	M10	67	28	●	●	100
0906 330 004	32	42.4	1-1/4	16x1.2	M10	71	27	●	●	100
0906 330 005	40	48.3	1-1/2	16x1.2	M10	76	30	●	●	100
0906 330 006	50	60.3	2	16x1.2	M10	78	26	●	●	100
0906 330 007	65	76.1	2-1/2	19x2.0	M10	99	38	●	●	50
0906 330 008	80	88.9	3	19x2.0	M10	117	50	●	●	50
0906 330 009	100	114.3	4	19x2.0	M10	131	51	●	●	50
0906 330 010	125	139.7	5	19x2.5	M12	155	55	●	●	25
0906 330 011	150	168.3	6	19x2.5	M12	196	84	●	●	25
0906 330 012	200	219.1	8	23x3.0	M12	203	66	●	●	25

Advantages/Benefits

- Approved for the fixing of sprinkler systems by FM and UL certifications.
- **Designed for suspending insulated pipe (with shield) or non-insulated pipe allowing for vertical adjustment.**
- One-piece design allows quick and easy installation of sprinkler pipes.
- Ideal for suspension using threaded pins and threaded rods.
- Simple height adjustment using the knurled nut.

Technical Data

- Material: Steel 1.0332 acc. to DIN EN 10111
- Zinc plating: Pre-galvanised acc. to DIN EN 10327
- Connection: Knurled nut